

### Building Sketch

Borrower	Mossman, James J.				
Property Address	3483 Daybreak Rdg				
City	Beaver Creek	County	Eagle	State	CO
Zip Code	81620				
Lender/Client	Goldman Sachs Bank USA				

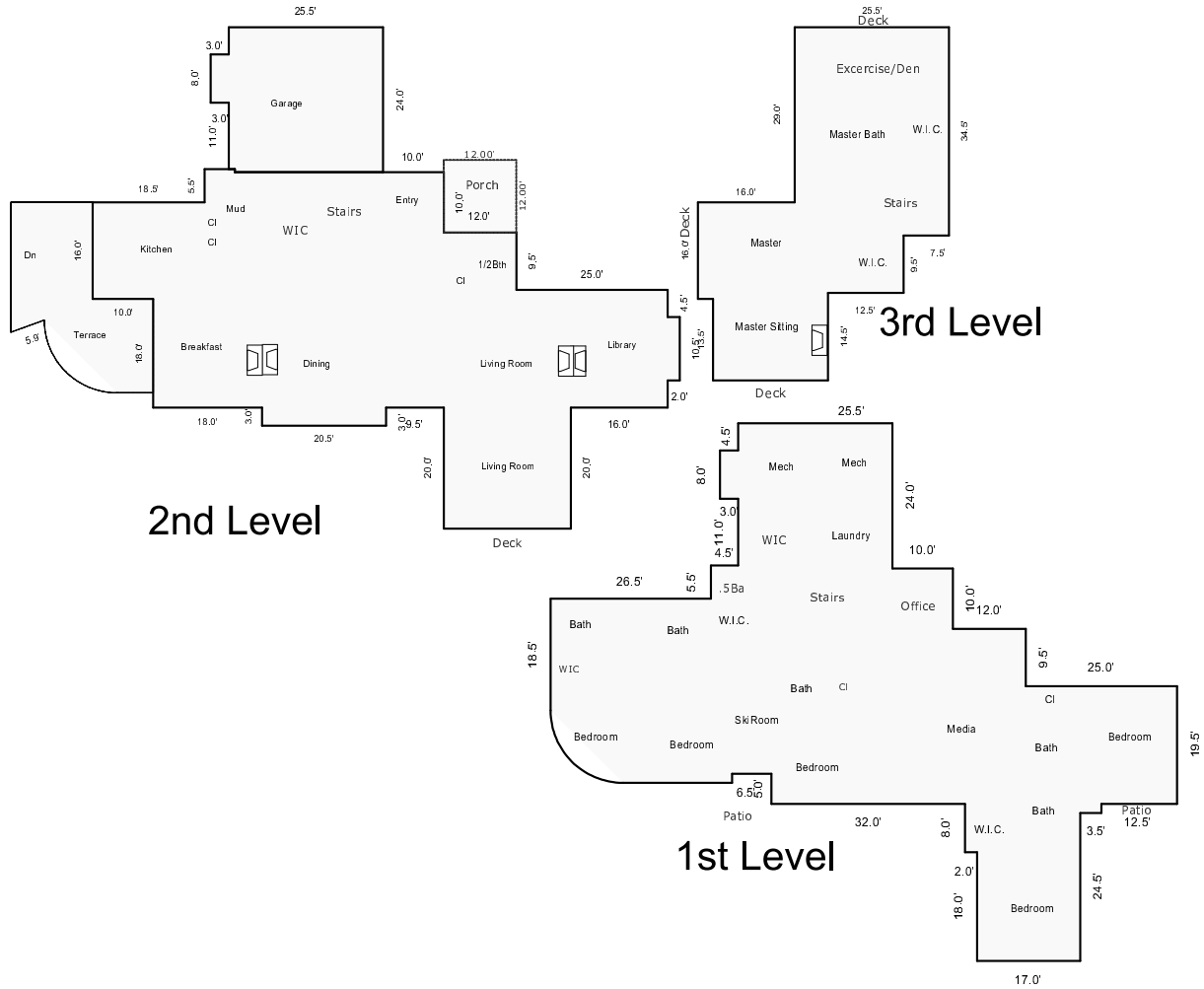

Sketch by Apex Sketch v5 Standard™

Comments:

AREA CALCULATIONS SUMMARY			
Code	Description	Net Size	Net Totals
GLA1	1st-BsmtAbvGrdWndws	4229.5973	4229.5973
GLA2	2nd - Above Grade	3330.0000	3330.0000
GLA3	3rd - Above Grade	1568.7500	1568.7500
GAR	Garage	635.5000	635.5000
P/P	Terrace	488.8473	
	Porch	144.0000	632.8473
Net LIVABLE Area		(rounded)	9128

LIVING AREA BREAKDOWN		
Breakdown		Subtotals
1st-BsmtAbvGrdWndws		
66.50	x	5.00
5.00	x	40.00
78.50	x	9.50
11.00	x	25.50
0.50	x	30.00
103.50	x	4.00
28.50	x	8.00
1.50	x	22.50
5.00	x	67.00
1.50	x	18.00
10.50	x	93.00
4.50	x	25.50
6.50	x	19.00
0.5	x	1.50
0.5	x	10.50
18.00	x	17.00
Curve	@	90.00°
2nd - Above Grade		
20.50	x	3.00
21.00	x	20.00
85.00	x	4.50
95.00	x	1.50
3.00	x	85.00
10.50	x	87.00
5.00	x	39.50
5.00	x	58.00
9.50	x	70.00
6		1571.2500
32 Items	(rounded)	9128